



"...the only port of call you'll ever need..."

## Mooring Winch



### Mooring Winch - Single Drum (Hydraulic Drive)

Product Code: WDH - A

| Model     | Pull Load<br>(kN) | Hawser Drum (at 1st layer) |                          |                             |      | Hawser Dia.<br>(mm) | Drum Dia.<br>(mm) | Hydraulic Motor        |  |
|-----------|-------------------|----------------------------|--------------------------|-----------------------------|------|---------------------|-------------------|------------------------|--|
|           |                   | Holding Load<br>(kN)       | Nominal Speed<br>(M/min) | Light-Line Speed<br>(M/min) | Type |                     |                   | Required Power<br>(kW) |  |
| WDH-A-050 | 50                | 150                        | 15                       | 30                          | 55   | 400                 | GM1               | 22                     |  |
| WDH-A-100 | 100               | 260                        | 15                       | 30                          | 65   | 400                 | GM2               | 50                     |  |
| WDH-A-125 | 125               | 350                        | 15                       | 30                          | 70   | 450                 | GM2               | 62                     |  |
| WDH-A-160 | 160               | 470                        | 15                       | 30                          | 70   | 450                 | GM2               | 75                     |  |
| WDH-A-200 | 200               | 590                        | 15                       | 30                          | 76   | 450                 | GM3               | 94                     |  |
| WDH-A-250 | 250               | 730                        | 15                       | 30                          | 80   | 450                 | GM4               | 110                    |  |

\* Hawser storage: 220m

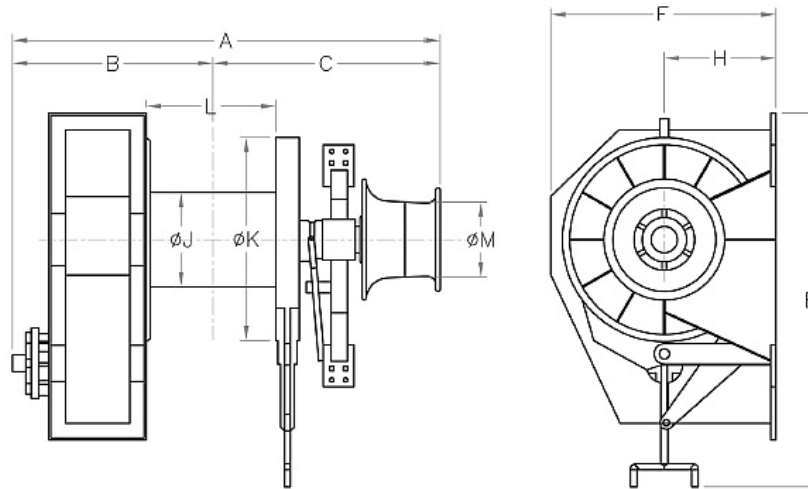

| Model     | Outside Dimensions (mm) |      |      |      |      |     |     |      |     |     |
|-----------|-------------------------|------|------|------|------|-----|-----|------|-----|-----|
|           | A                       | B    | C    | E    | F    | H   | J   | K    | L   | M   |
| WDH-A-050 | 2600                    | 1400 | 980  | 1560 | 1420 | 620 | 400 | 1200 | 800 | 400 |
| WDH-A-100 | 2650                    | 1550 | 1100 | 1800 | 1600 | 750 | 400 | 1360 | 880 | 400 |
| WDH-A-125 | 2785                    | 1650 | 1135 | 1850 | 1600 | 760 | 450 | 1560 | 880 | 400 |
| WDH-A-160 | 3010                    | 1800 | 1210 | 1900 | 1700 | 760 | 450 | 1560 | 880 | 450 |
| WDH-A-200 | 3155                    | 1900 | 1255 | 2200 | 1800 | 800 | 450 | 1660 | 920 | 450 |
| WDH-A-250 | 3285                    | 2000 | 1285 | 2300 | 1950 | 900 | 450 | 1730 | 920 | 450 |

#### Remarks:

1. Compact design minimise space required for installation
2. Simple design along with integrated and sealed for ease of inspection and maintenance
3. Total enclosed gear type and local control
4. Hydraulic Brake, Clutch on request
5. Remote control or Auto-Tension is available on request
6. Electric driven with frequency inverter on request